

Initial Set Up

One reason people love the Skeeter Defeater™ Automatic Dispenser is because it's so easy to set up and maintain. Follow the instructions below to quickly have your Dispenser defending your yard.

Battery Installation

The Skeeter Defeater Dispenser requires 4 AA batteries, which are sold separately. These batteries last approximately two months before they need to be replaced.

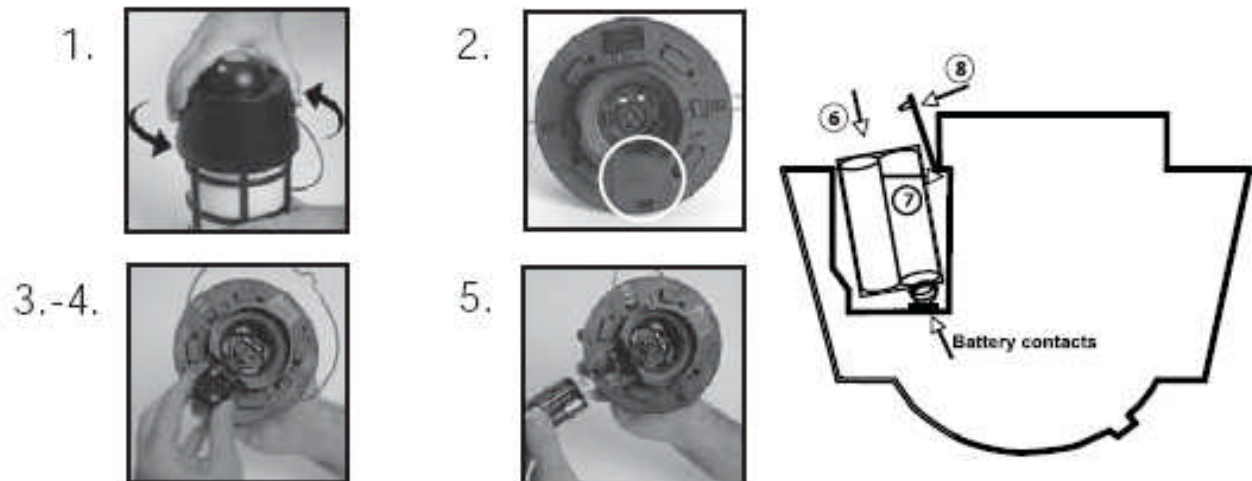

1. Twist the Spray Head of Dispenser counter-clockwise to remove from the Base.
2. Locate the Battery Chamber on the underside of the Spray Head.
3. Release the tab to the Battery Chamber Door and remove it.
4. Remove the Battery Holder from the Battery Chamber by pushing the Holder outward to unlock it from the Chamber.
5. Insert 4 AA batteries into the Battery Holder, paying close attention for proper connections. Be sure to align the positive (+) and negative (-) connections properly.
6. Insert the Battery Holder back into the Battery Chamber, and verify that the battery contact springs are aligned and contacting the metal contact points.
7. Push the Battery Holder down and toward the center of the Spray Head to lock into place.
8. Lock the Battery Chamber Door back into place. If the Chamber Door refuses to close completely, then the Battery Holder is not properly locked. Repeat step 7.